

Whistler Suite
Room height 3.2m

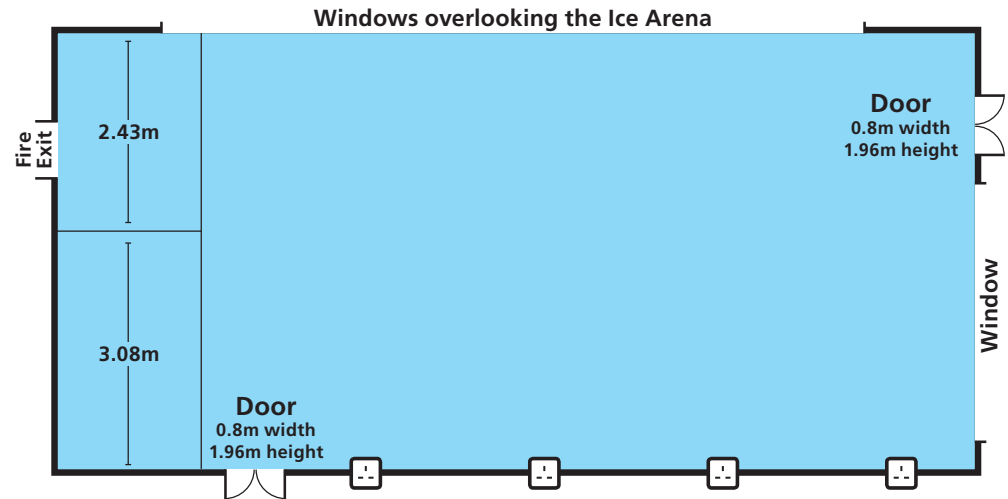

Room 1
Room height 2.66m

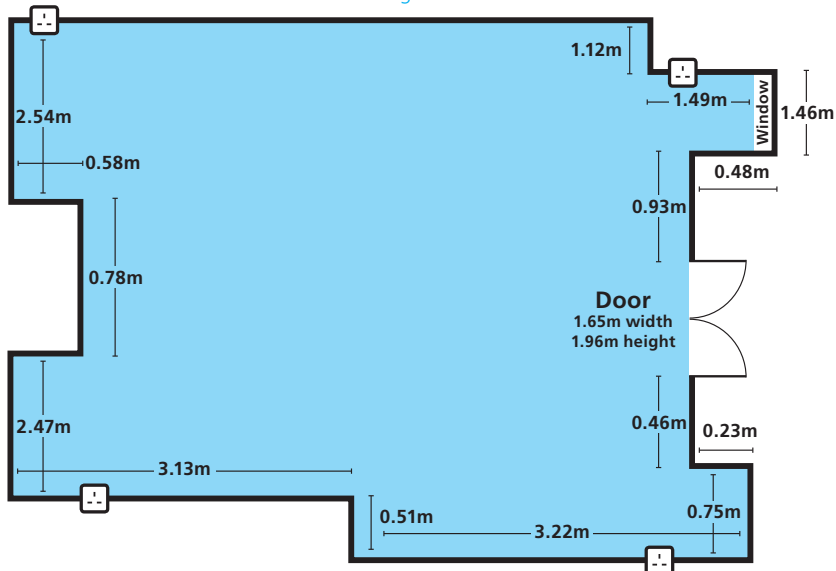

Rooms 2 & 3
Room height 2.66m.
Room 2 is a mirror image of Room 3.

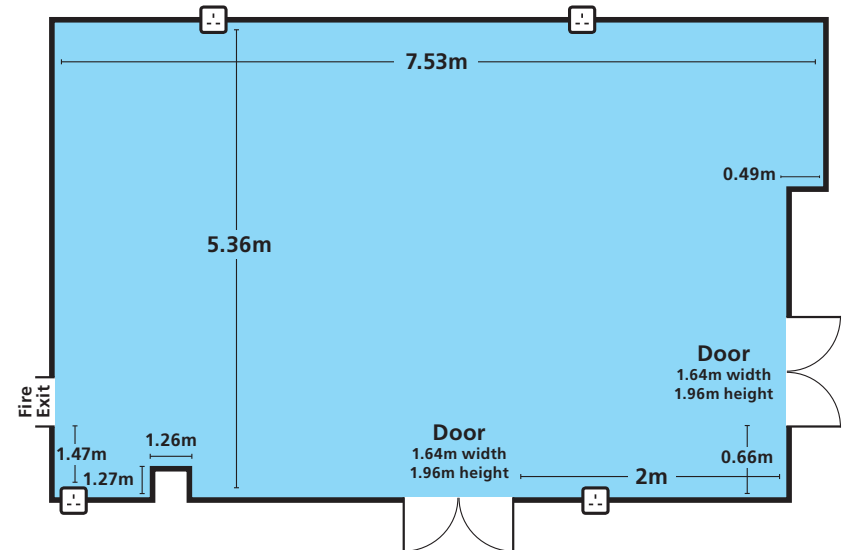

SnowDome Capacity Chart

Seating Style	Tirol Suite	Whistler Suite	Rooms 1, 2 & 3
Theatre style	200 (using the L) 150 (without using the L)	80	30
Cabaret style	100 (without using the L)	50	N/A
U Shape	30	30	15 (Room 1) 20 (Rooms 2 & 3)
Boardroom	40	30	16
Reception/Standing	450	100	30
Banqueting with Buffet	170	60	N/A
Banqueting with sit down	190	N/A	N/A

